



WITRUS PRIVATE LIMITED



WITRUS

#06 Andrahalli Main Road Pennya 2nd Satge Vishwaneedam Post
Bangalore - 560091 7019386466

www.witrus.com sales@witrus.com

GSTIN : 29AACCW7027L1ZU



**Self Clinching Nut S
WFMS3N DataSheet**

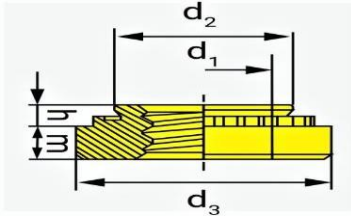

Size→ Dimension↓	Tol	M2x0.4	M2.5x0.45	M3x0.5	M3.5x0.6	M4x0.7	M5x0.8	M6x1.0	M8x1.25	M10x1.5
Collar dia d2	max	4.22	4.22	4.22	4.73	5.38	6.38	8.72	10.47	13.97
Nut dia d3	±0.25	6.25	6.35	6.35	7.10	7.87	8.64	11.18	12.70	17.35
Nut thickness m	±0.25	1.50	1.50	1.50	1.50	2.00	2.00	4.08	5.47	7.48
Hole Size in Sheet	+0.08	4.25	4.25	4.25	4.75	5.40	6.40	8.75	10.50	14.00
Minimum edge distance to hole centre		4.80	4.80	4.80	5.60	6.90	7.10	8.60	9.70	13.50

Quote the item code given below with your order/ inquiries:

Dimensions in mm

Size	Shank Code	PART NUMBER	Min Sheet Thickness sm	h (Shank) Max.	Press In KN		Push out N		Torque out Nm	
					Aluminium	Steel	Aluminium	Steel	Aluminium	Steel
M2x0.4	0	WFMS3N02000	0.80	0.77	6.7 - 8.9	11.2 - 15.6	280	470	0.90	1.47
	1	WFMS3N02001	1.00	0.97						
	2	WFMS3N02002	1.40	1.38						
M2.5x0.45	0	WFMS3N20500	0.80	0.77	6.7 - 8.9	11.2 - 15.6	280	470	0.90	1.47
	1	WFMS3N20501	1.00	0.97						
	2	WFMS3N20502	1.40	1.38						
M3x0.5	0	WFMS3N03000	0.80	0.77	6.7 - 8.9	11.2 - 15.6	280	470	0.90	1.47
	1	WFMS3N03001	1.00	0.97						
	2	WFMS3N03002	1.40	1.38						
M3.5x0.6	0	WFMS3N30500	0.80	0.77	11.2 - 13.4	13 - 26	280	490	1.80	2.30
	1	WFMS3N30501	1.00	0.97						
	2	WFMS3N30502	1.40	1.38						
M4x0.7	0	WFMS3N04000	0.80	0.77	11.2 - 13.4	18 - 27	300	490	2.37	2.95
	1	WFMS3N04001	1.00	0.97						
	2	WFMS3N04002	1.40	1.38						
M5x0.8	0	WFMS3N05000	0.80	0.77	11.2 - 15.6	18 - 38	300	530	3.00	3.60
	1	WFMS3N05001	1.00	0.97						
	2	WFMS3N05002	1.40	1.38						
M6x1.0	0	WFMS3N06000	1.20	1.15	11.2 - 13.4	27 - 36	970	1380	7.90	13.00
	1	WFMS3N06001	1.40	1.38						
	2	WFMS3N06002	2.30	2.21						
M8x1.25	1	WFMS3N08001	1.40	1.38	11.2 - 15.6	27 - 36	1570	1870	13.60	18.70
	2	WFMS3N08002	2.30	2.21						
M10x1.5	1	WFMS3N10001	2.31	2.21	18 - 32	32 - 50	1760	2020	32.70	36.20
	2	WFMS3N10002	3.18	3.05						